

Gippsland Regional Aquatic Centre

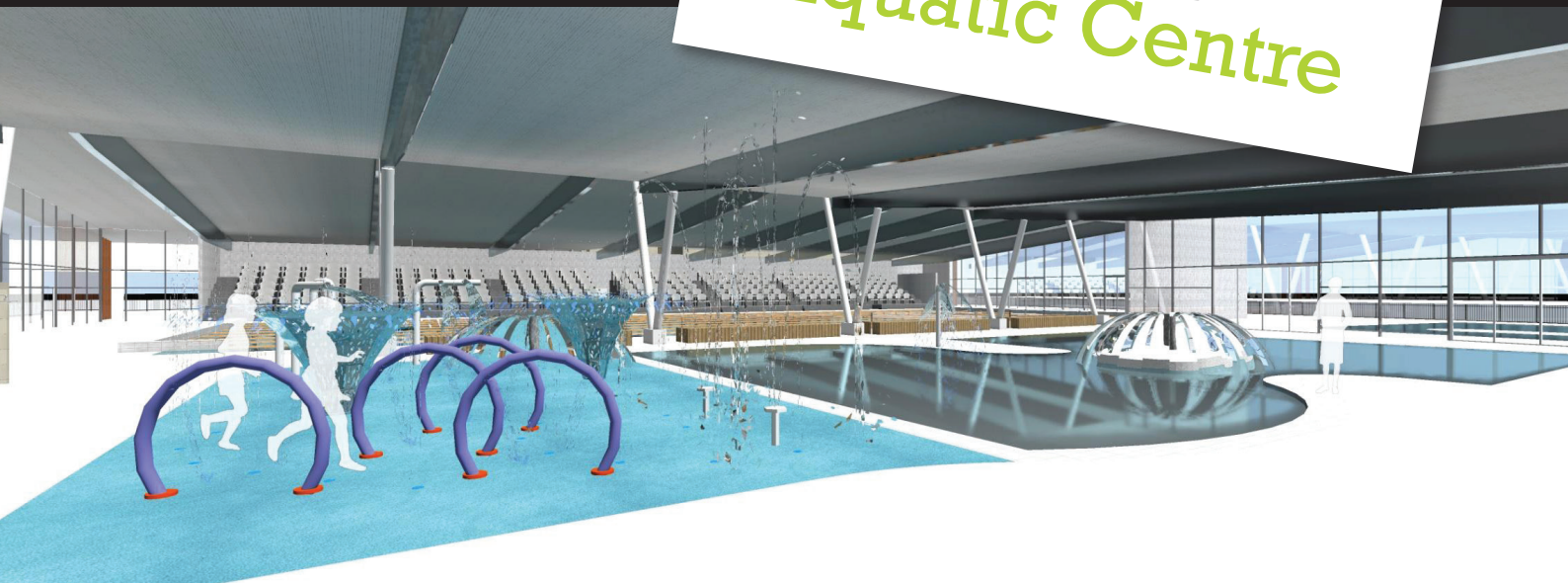

The concept designs for the proposed **Gippsland Regional Aquatic Centre** in Traralgon have now been formally adopted by Council. The facility would be the only competition 50 metre indoor facility between eastern Melbourne to the New South Wales border.

It's an exciting design for a centre that has the potential to be a huge attraction not only for Traralgon and Latrobe City but also for the greater Gippsland region. The facility is set to become the centre of swimming in the region and would be known as the Gippsland Regional Aquatic Centre.

What will the proposed facility include?

The concept designs include:

- 50m 8 lane competition heated indoor pool with a dividing boom
- Spectator seating
- Indoor program/warm water pool
- Children's play zero dept area
- Toddlers pool
- Outdoor 25m 4 lane heated pool with beach entry
- Full disability access to all pools
- Modern change facilities including change village
- Group change facilities
- Kiosk and café seating
- Multi purpose room
- Additional car parking including disabled
- Retention of large gum trees
- Swim club rooms
- Storage areas and plant room
- Geothermal heating and cooling



Who was involved?

In June 2011 the Traralgon Indoor Aquatic Facility Working Party was formed. The working party includes representatives of a number of key stakeholder groups including:

- **Traralgon Swimming Club;**
- **Traralgon Community Development Association;**
- **Save Hubert Osborne Park Group;**
- **and**
- **Traralgon Croquet Club.**

The Working Party worked cooperatively throughout the process. The group was clear about the most important elements and what it would like to see. This was taken into account in the development of the project brief for the indoor aquatic facility on the current outdoor pool site.

Etch Architectural Solutions were appointed to work with the stakeholder group and Council officers to develop these concept plans and cost estimates for the project.



How much will it cost to build?

The proposed Gippsland Regional Aquatic Centre will cost approximately \$30 million to construct.

Latrobe City Council's 10 Year Financial Plan includes a \$12 million allocated for this project. The balance of funding (approximately \$18 million) will need to be sourced from the Federal and State Governments.



Key considerations for the design

The architect and working party took into account the following key elements during the design phase:

Visual Direction & Access

- Easy way-finding
- Disability & Emergency Access

Visual & Physical Permeability

- Visual and physical permeability
- Strong axial pathways

Defined Pedestrian & Vehicle Zones

- Control and allow for safer movement

Continuity

- 'sense of place' & unity of the site as a 'precinct'

25m outdoor pool

- Retention of an outdoor pool for the summer season. This was also a consistent message during the consultation for the Indoor Aquatic Facility Feasibility Study. This outdoor pool also can be used for swimming carnivals as a warm up and down pool.

Warm water pool

- The inclusion of a warm water pools that could be used by health professionals for rehabilitation.

Group fitness and gym

- Due to the sufficient provision of private gymnasiums and fitness centres in Traralgon it was identified that this feature was not warranted in the development.

Safety

- Clear 'visual' access to and from the car park to the aquatic centre and adjoining parkland. Adequate protection for patrons, especially at night (lighting).

Planted Buffer Zones

- Provides for flora & fauna
- Minimises 'night' pollution (noise and light)

Retention of existing large trees

- Retain as many of the large gum trees as possible due to the park setting and treed precinct.

How much will it cost to run?

Operating a facility of this size and nature, particularly without a gymnasium component will cost Council and ratepayers significantly more to operate per year than the current outdoor facility.

Whilst the current Traralgon Outdoor Pool costs less than \$100,000 per annum to operate, the operational cost estimate report indicates approximately \$750,000 will be required to maintain and manage the proposed new facility.

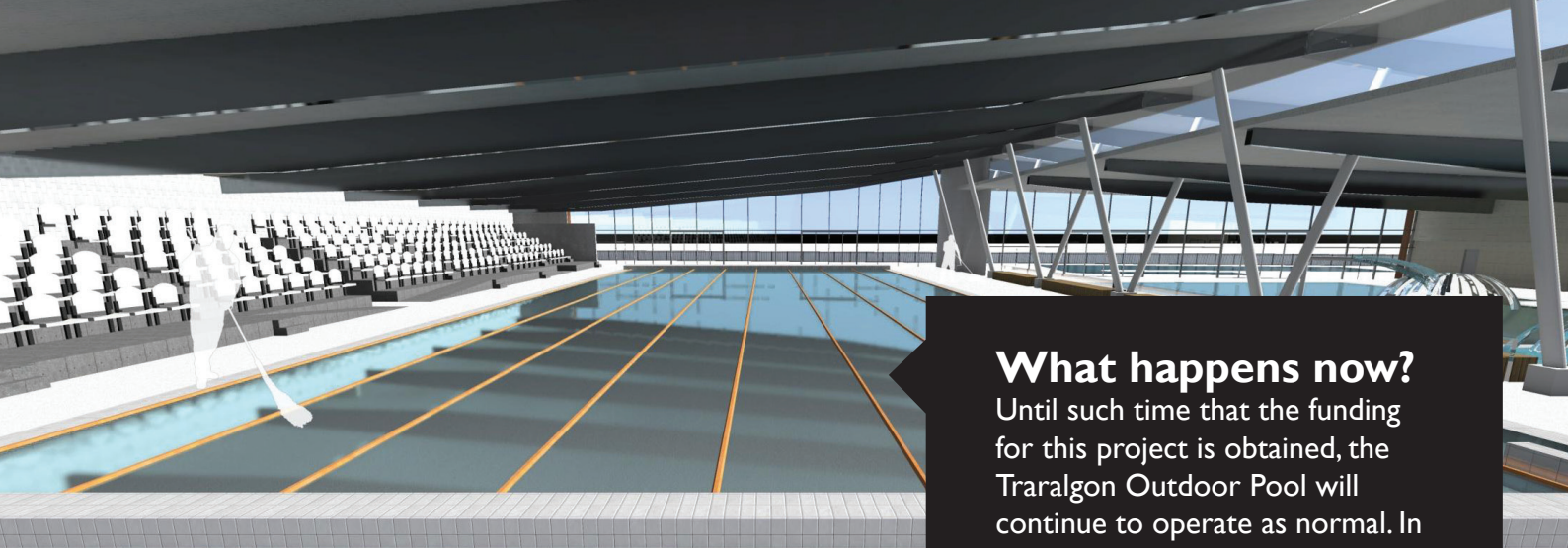

What happens now?

Until such time that the funding for this project is obtained, the Traralgon Outdoor Pool will continue to operate as normal. In the event funding is sourced, the outdoor pool is likely to be closed for at least one season while construction takes place.

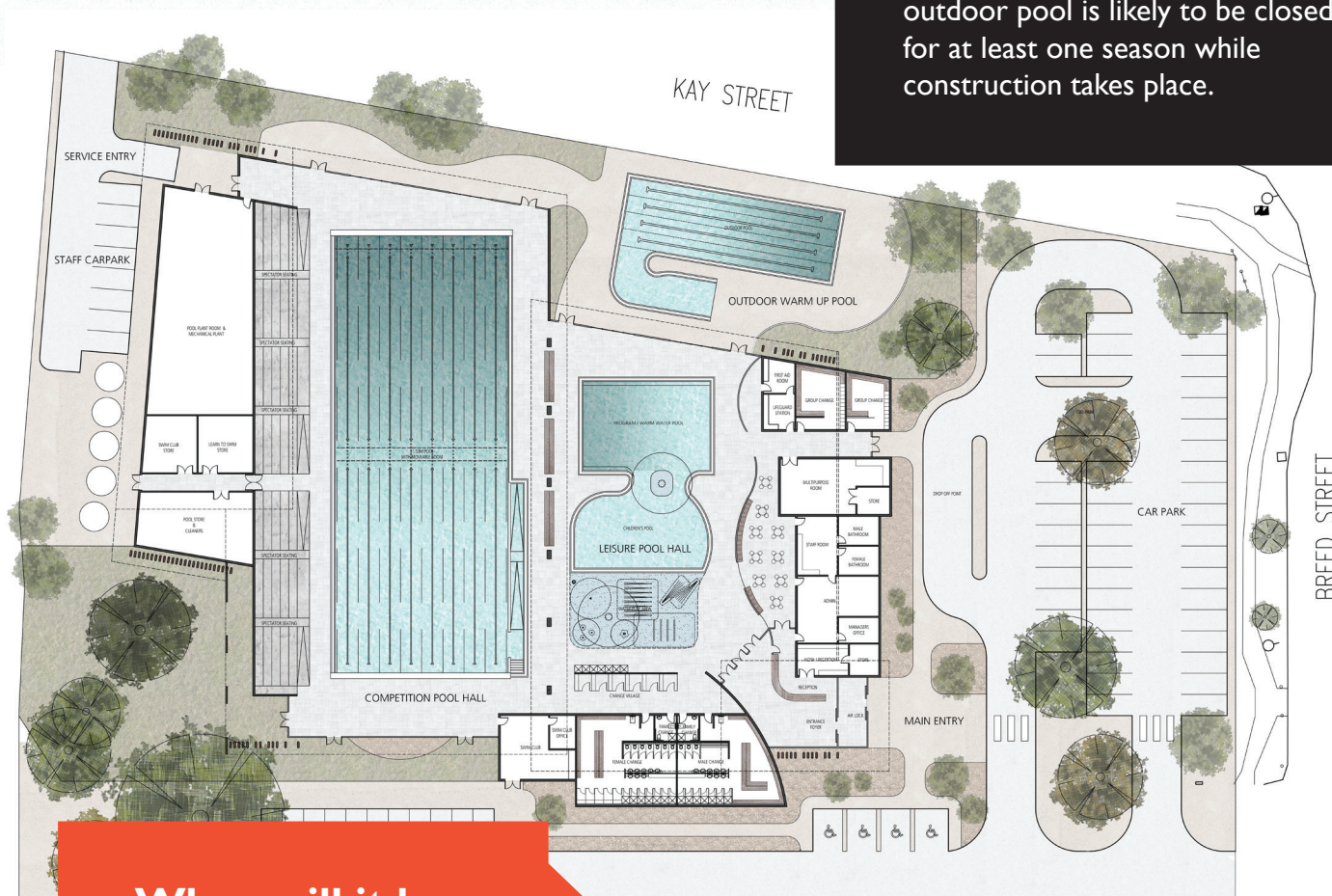

When will it be built?

The project is now reliant on significant funding to be obtained for it to come to fruition. With the concept design being adopted, Council will now actively pursue external funding. Acquiring funding of this magnitude will take some time.

Further information & feedback

Visit www.latrobe.vic.gov.au to access the full Gippsland Regional Aquatic Centre report.

Hard copies of the feasibility study are available at Council Service Centres and Latrobe Leisure Centres.

For further information, please contact Jamey Mullen, Manager Recreational Liveability on 5128 5629 or Email jameymu@latrobe.vic.gov.au